



EUROPEAN
CHAMPIONSHIPS
CYCLING
MUNICH 2022

TECHNICAL GUIDE

UEC TRACK ELITE
EUROPEAN CHAMPIONSHIPS

MUNICH (GERMANY)

11 – 16 AUG 2022



Dear Cycling Community,

Welcome to European Championships Munich 2022!

Munich 2022 is the largest multi-sport event in Germany since the 1972 Summer Olympic Games. From 11–21 August, European sport unites as elite athletes compete in nine different sports (athletics, beach volleyball, canoe sprint, cycling, gymnastics, rowing, sport climbing, table tennis, triathlon) for the highest accolade of their sport on the continent – the title of European Champion.

No other sport is as multifaceted, suitable for everyday life and appeals to such a wide range of audience as Cycling does. With a jam-packed programme of Track and Road Cycling, BMX Freestyle and MTB Cross-Country, Munich 2022 guarantees everything a Cycling enthusiast could wish for and will showcase the beautiful Bavarian capital and all its spectacular surroundings.

The Individual Time Trial takes place in neighbouring Fürstentfeldbruck while Road Race cyclists will be treated to an extra dose of Bavarian charm, with the scenic lakes and mountains in Murnau a. Staffelsee and Landsberg am Lech providing a picturesque backdrop for the hotly anticipated race into Munich city centre.

MTB Cross-Country and BMX Freestyle Park competitors will also be at the heart of the action at Olympiapark - Munich 2022's **central and pulsating hub**. Furthermore, a purpose-built velodrome awaits competitors for the track events with space for 1700 enthusiastic fans at Messe München.

The anticipation is rising here in Munich and we cannot wait to showcase our wonderful venues to you all in August. Until then, we wish you all a safe, enjoyable, and healthy lead up to European Championships Munich 2022.

Best regards,

Munich 2022 Local Organising Committee

TABLE OF CONTENTS

DISCOVER MUNICH'S TOP TOURIST SPOTS.....	5
ORGANISATION	6
ADDRESS	6
WEBSITE	6
CONTACT	6
LOCAL ORGANISING COMMITTEE	6
LOCAL ORGANISING COMMITTEE: TRACK CYCLING	6
UEC REPRESENTATIVES.....	7
GENERAL INFORMATION	8
TRAVEL AND ACCOMMODATION.....	8
HOTEL LOCATIONS.....	8
HOTEL INFORMATION.....	8
ACCOMMODATION	9
ARRIVALS AND PICK-UP SERVICE.....	9
ATHLETES' TRANSPORT.....	9
PARKING INFORMATION.....	9
ACCREDITATION.....	10
VENUE ACCREDITATION CENTRE.....	10
ACCREDITATION ZONES	11
DRIVING IN MUNICH	11
RIDERS' SAFETY ON THE ROADS.....	12
VISAS	12
RADIO EQUIPMENT.....	12
SMOKING POLICY.....	12
MONEY.....	12
LANGUAGE.....	13
TAP WATER.....	13
ELECTRICITY	13
TELEPHONE.....	13
MEDICAL/EMERGENCY.....	13



HOSPITALS.....	13
URGENT MEDICAL CARE.....	14
EMERGENCY.....	14
OFFICIAL DOCTOR.....	14
MUNICH 2022 STUDY.....	14
COVID-19 MEASURES AND RECOMMENDATIONS.....	14
SOCIAL MEDIA.....	16
USE OF DRONES.....	16
OFFICIAL OPENING MUNICH 2022.....	16
THE ROOFS (FESTIVAL OF MUNICH 2022).....	16
ATHLETES' ROOF (OLYMPIAPARK).....	17
ATHLETES' TICKETS.....	17
SPECTATORS' TICKETS.....	17
SUSTAINABILITY.....	17
GENERAL INFORMATION.....	17
ACCESSIBILITY.....	18
WASTE MANAGEMENT.....	18
EUROPEAN CHAMPIONSHIPS MUNICH 2022 – SPORTS PROGRAMME.....	18
TRACK CYCLING INFORMATION.....	19
OFFICIALS.....	19
UEC TRACK COMMISSION.....	19
COMPOSITION OF THE COMMISSAIRES' PANEL.....	19
COMPETITION VENUE / TEAM PARKING AREA.....	19
PERMANENCE.....	20
OFFICIAL MEETINGS SCHEDULE.....	20
CONFIRMATION OF STARTERS.....	20
TEAM MANAGERS' MEETING.....	20
COMMISSAIRES' PANEL MEETING.....	20
TRAINING SCHEDULE.....	21
COMPETITION SCHEDULE.....	21
TRACK SPECIFICATIONS.....	27



TRACK CENTRE – TEAM BOXES.....	27
RIDER SAFETY RULES	27
TEAM MEDICAL	27
TEAM PERFORMANCE ANALYSTS.....	27
ON-BIKE CAMERAS.....	28
INTERVIEW MIXED ZONE	28
RESULTS DISTRIBUTION.....	28
ROLLERS.....	28
TEAM STORAGE AREA.....	28
ATHLETES’ LOUNGE AT THE VENUE.....	28
TEAM CHANGING ROOMS & SHOWERS	28
ICE BATH.....	29
SEATING OPTIONS FOR ATHLETES	29
TEAM CATERING AT THE VENUE	29
TEAM CATERING AT THE HOTEL.....	29
ANTI-DOPING CONTROL.....	29
TRACK CYCLING VENUE: MESSE MÜNCHEN	30
TRACK ELITE EUROPEAN CHAMPIONSHIPS SPECIFIC REGULATIONS 2022.....	34

DISCOVER MUNICH'S TOP TOURIST SPOTS

Marienplatz

The heartbeat of Munich: Marienplatz (St. Mary's Square), the world-famous centre of the Bavarian capital, is home to the New Town Hall. At any time of year, there's always something happening near the Mariensäule (Column of St. Mary) – whether it's people gathering to witness the Glockenspiel (carillon housed in the Town Hall), the Christmas market, championship celebrations for major sports teams or simply visitors from all over the world strolling through the city.



Nymphenburg Palace

Travel back in time to the age of the Bavarian monarchy: the extensive park with its pavilions, promenades along the palace canals, enormous fountains, magnificent flower gardens and, of course, impressive palace buildings is a source of fascination for Munich natives and tourists alike. In addition to the rooms inside the palace, which were designed by the best sculptors, painters and plasterers of the time, you can visit several museums housed in the palace itself, including the Museum of Man and Nature and the Museum of Nymphenburg Porcelain.

Viktualienmarkt

Viktualienmarkt is Munich's largest market and a hub for the city's foodies. Spread across 22,000 square metres, it features a vast range of fresh produce with much more than just fruit and vegetables: Bakers, butchers, fishmongers, delicatessens, and flower stalls have turned Viktualienmarkt into a Munich landmark for more than 200 years. The best thing: entry to the market is free with food stalls and a relaxing beer garden, complete with an authentic Bavarian Maypole, awaiting.



Hofbräuhaus

German "Gemütlichkeit" and traditional beer drinking rituals are paramount at the Hofbräuhaus on the Platzl square in Munich. Doors open daily at 9:00 am, seven days a week with music, folk dances, regional cuisine, waiters in costumes and the historic atmosphere attracting Munich natives and thousands of thirsty visitors from all over the world. The imposing Neo-Renaissance building remains a unique attraction. The interior has space to serve up to 3,000 guests, and additionally up to 400 seating places in the open-air beer garden outside.

Deutsches Museum

The largest technology museum in the world: The German Museum of Masterpieces of Science and Technology, as it's officially called, is both a traditional museum and a modern, hands-on facility. Visitors can enjoy demonstrations, experiments, and media stations, where they can press buttons, flip levers and switches and touch the exhibits. The 50 or so subjects covered by the museum are diverse, ranging from agriculture and food technology to astronomy, chemistry, photography and film, aeronautics and space technology, marine biology, and physics to shipping, telecommunications and even clocks.



ORGANISATION

ADDRESS

European Championships Munich 2022
LOC Office
Spiridon-Louis-Ring 22
80809 Munich

WEBSITE

<https://www.munich2022.com/>

CONTACT

trackcycling@munich2022.com

LOCAL ORGANISING COMMITTEE

Managing Director Olympiapark München GmbH	Marion Schöne (GER)
Head of LOC	Frank Seipp (GER)
Head of LOC	Markus Schnetzer (GER)
Head of Sports & Competition	Philip Frankenberger (GER)

LOCAL ORGANISING COMMITTEE: TRACK CYCLING

Project Manager	Maria Meinel (GER) +49 160 6157306
Competition Manager	Alexander Donike (GER)
Assistant Competition Manager	Mario Vonhof (GER)
Assistant Project Manager	Sarah Grede (GER)
Team Assistant	Paulina Klimsa (GER)
Official Doctor	Dr. Dirk Tenner +49 162 271 5860 dirk.tenner@t-online.de



UEC REPRESENTATIVES

President	Enrico Della Casa (ITA)
Vice-President	Henrik Jess Jensen (DEN)
Vice-President	Delmino Albano Magalhães Pereira (POR)
Member	Katarina Jakubova (SVK)
Member	Dragomir Kouzov (BUL)
General Secretary	Alasdair MacLennan (GBR)
UEC Race Secretary	Lino Nossa (POR)
Technical Delegate	Vladimiro Petsas (GRE)
Press Officer	Stefano Bertolotti (ITA)
Photographer	Roberto Bettini (ITA)
Photographer	Luca Bettini (ITA)
Video Recording	Christian Bohm (ITA)

GENERAL INFORMATION

TRAVEL AND ACCOMMODATION

HOTEL LOCATIONS

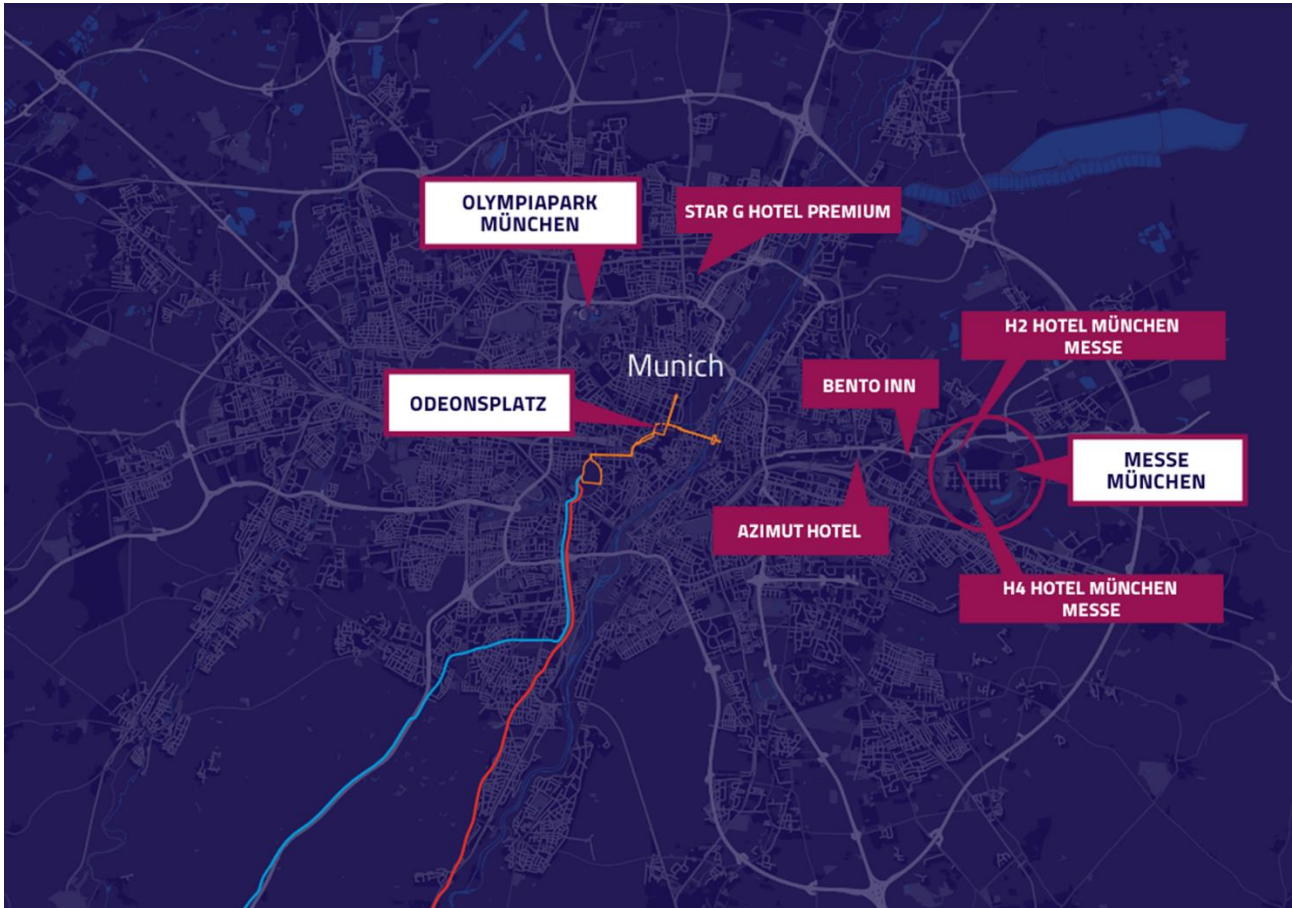

HOTEL INFORMATION

H2 Hotel München Messe
 Olof-Palme-Straße 12, 81829 Munich
 48°08'11.0"N 11°41'23.5"E
 48.136384, 11.689846

Bento Inn München Messe
 Stahlgruberring 45, 81829 Munich
 48°08'07.5"N 11°40'10.5"E
 48.135422, 11.669584

H4 Hotel München Messe
 Konrad-Zuse-Platz 14, 81829 Munich
 48°08'14.5"N 11°41'22.2"E
 48.137367, 11.689506

AZIMUT Hotel
 Kronstadter Straße 6-8, 81677 Munich
 48°08'13.7"N 11°38'54.6"E
 48.137130, 11.648505

Distances from the hotels to the Team Parking Area at Messe München:

H2 Hotel München: 1.1 km (on foot: 13 minutes, by car: 3 minutes)

H4 Hotel München Messe: 950 m (on foot: 12 minutes, by car: 3 minutes)

Bento Inn München Messe: 3.0 km (on foot: 38 minutes), 2.5 km (by car: 5 minutes)

AZIMUT Hotel: 4.3 km (on foot: 55 minutes), 4.5 (by car: 6 minutes)

ACCOMMODATION

Please note that all accredited teams that have booked accommodation through the Munich 2022 LOC still need to provide the personal data of all team members for the respective hotel rooms that have been booked.

The deadline for accommodation booking by name is 1 August 2022 via our Event Management System (EMS).

Please write a brief email to trackcycling@munich2022.com if you require access to our Event Management System (<https://ems.munich2022.com/#/login>).

ARRIVALS AND PICK-UP SERVICE

All accredited teams and officials, who have booked accommodation through the Munich 2022 LOC and adhered to the booking deadlines will be provided with transportation from Munich Airport or the main train station to the hotel and vice versa. To make use of this service, you must register your arrival and departure dates via our Event Management System (EMS). The deadline for travel details is 1 August 2022. During this process, teams are also required to communicate if oversized luggage (e.g. bicycles) must be transported. If this data is not provided, the LOC will not take on responsibility of this matter.

Munich Franz-Josef Strauss Airport is located 32 kilometres (30-minute drive) and Munich main train station is located 15 kilometres (30-minute drive) away from Messe München for Track Cycling and Road Cycling Permanence.

ATHLETES' TRANSPORT

Transportation for athletes and teams between their respective hotel and the venue will not be provided as all the hotels are nearby.

PARKING INFORMATION

As mentioned in our booking form regarding your vehicle inquiries, parking space at the hotels is limited. Hence, we are providing Road and Track Cycling teams with a dedicated parking area at Messe München. This parking lot will supply your team cars with access to water and electricity. However, sewage should never be discharged on the parking lot as there is no wastewater connection. A suitable sewage point will be signposted on site. Additionally, this area is going to be fenced in and security guards will provide 24-hour surveillance. However, the LOC cannot accept any liability.

The Team Parking Area can be entered through Gate 19 via Paul-Henri-Spaak-Straße. As parking space is limited, the access to the venue will be managed using a Vehicle Access and Parking Permit (VAPP). VAPPs are distributed to the teams when having filled out our parking space inquiry. The number of VAPPs is limited and is based on the information provided in the parking analysis. The VAPPs can be picked up at the Venue Accreditation Centre at the entrance of the Team Parking Area during the opening times of the Parking Area.

If teams need space for mechanical work or cleaning, the LOC recommends using the Parking Area at Messe München. Teams will also be provided with water and power lines. Additionally, one clean bicycle per person can also be taken to hotel rooms. However, please note, that the hotel room only offers limited space.

Opening Hours Messe München Parking Area (subject to change):

8 August	Arrival Track Cycling Teams	07:00 – 23:00
9 August	1 st Training Track Cycling	07:00 – 23:00
10 August	2 nd Training Track Cycling	07:00 – 23:00
11 August	3 rd Training & Qualification Track Cycling	07:00 – 23:00
12 August	Competition Day Track Cycling	07:00 – 23:59
13 August	Competition Day Track Cycling	06:30 – 23:59
14 August	Competition Day Track Cycling Men's Elite Road Race Murnau	05:00 – 23:59
15 August	Competition Day Track Cycling	07:00 – 23:59
16 August	Competition Day Track Cycling	07:00 – 23:59
17 August	Women's and Men's Elite Individual Time Trial FFB	07:00 – 23:00
18 August		07:00 – 23:00
19 August		07:00 – 23:00
20 August		07:00 – 23:00
21 August	Women's Elite Road Race Landsberg	05:00 – 23:00
22 August	Departure Day Road Cycling Teams	07:00 – 23:00

ACCREDITATION

Munich 2022 will operate one single accreditation system across all sports and all venues for the European Championships. The Main Accreditation Centre is located at Olympiapark, however, please note that the Road and Track Cycling teams will be provided with their accreditation at the entrance of the Team Parking Area at Messe München starting 8 August 2022. The Team Parking Area can be entered through Gate 19 via Paul-Henri-Spaak-Straße. Team managers are requested to collect the badges for their entire team and distribute them accordingly. The managers are asked to confirm their identity at collection via a passport or national identity card and sign a confirmation for reception of all accreditations. Please be aware: For accreditation, athletes must provide a photo in our EMS after their final registration via the UEC so that their identity can be verified on site. As the final registration via the UEC website will only be completed 12 days before the first competition (30 July), we kindly ask to upload the photos and personal information immediately after, at the latest by 1 August 2022! Otherwise, athletes must present themselves personally at the Venue Accreditation Centre to take a photo for their accreditation. Please note that a fee of €100 will be charged when an accreditation is lost.

VENUE ACCREDITATION CENTRE

Address:

Messe München – parking place access at Gate 19 from Paul-Henri-Spaak-Straße, 81829 Munich

48°08'23.1"N 11°41'49.3"E

48.139750, 11.697028

Opening Hours Messe München Accreditation Centre (VAC) at the Team Parking (subject to change):

Date	Open VAC	Close VAC
8 August	08:00	19:00
9 August	08:00	19:00
10 August	08:00	19:00
11 August	08:00	13:00
12 August	08:00	19:00
13 August	08:00	19:00
14 August	07:00	13:00
15 August	08:00	19:00
16 August	08:00	19:00
17 August	08:00	13:00
18 August	08:00	13:00
19 August	08:00	19:00
20 August	08:00	19:00
21 August	07:00	13:00

ACCREDITATION ZONES

Accreditation Zone privileges are printed on the accreditation card as well as other personal information.

Access will be controlled in front of the respective area through the number(s) on the accreditation card and granted if the respective person is permitted to use that zone.

The accreditation card must always be worn and displayed within an accredited venue.

Accreditation Zones	
Zone	Area
1	Field of Play
2	Athletes' Area
3	Warm-up Areas
4	Training Area
5	Administrative and Operational Area
6	Media Area
7	Media Mixed Zone
8	Broadcasters' Areas
9	VIP Hospitality

DRIVING IN MUNICH

Please remember to follow German traffic laws, including the Sunday and holiday driving ban for trucks heavier than 7.5 tons and obtain the **environmental badge needed for driving in Munich's city centre**. Environmental zones are indicated with a traffic sign "Umwelt ZONE." An additional sign underneath then specifies what type of

environmental badge you need. You may have to pay a fine of up to €80 if you enter these eco zones without a valid environmental badge. For more information, please follow this link: <https://www.germanemissionssticker.com/>

RIDERS' SAFETY ON THE ROADS

- Whilst out on the roads remember to not ride on the highway
- After dark you require a front and back light fitted to your bike
- Ensure you adhere to all road signs and do not ride on the footpath; this is illegal and may result in a fine
- Please make sure you have your ID with you when you are outside the venue

VISAS

Citizens of the European Union and the Schengen Area are not required to apply for a visa when entering Germany. However, residents from the following countries must apply for a visa at an embassy of the Federal Republic of Germany: Albania*, Armenia, Azerbaijan, Bosnia and Herzegovina*, Georgia*, Kosovo, Moldova*, Montenegro*, North Macedonia*, Serbia*, Turkey and Ukraine*. If invitation letters are required, the LOC will gladly fill out the necessary document. For further information please check the respective section on the website of the [German Federal Foreign Office](#).

*Only if the national citizen does not hold a biometric passport.

RADIO EQUIPMENT

All users, who are planning to use wireless devices (such as walkie talkies, wireless cameras, microphones, PMR446, DECT systems and WIFI routers) during the European Championships Munich 2022, already had to submit their requirements to Munich 2022 via the Spectrum Order Portal due to a limited availability of radio resource within the venues.

Upon arrival in Munich these registered users are required to have their wireless equipment validated at the Spectrum Desk. The validation of such devices will be done at Messe München after the dedicated Team Managers' Meeting. The Spectrum Desk team will examine the wireless equipment to ensure that it matches the specifications outlined in the radio licence. All wireless equipment must be programmed to the frequency assigned ahead of time. Once the validation is completed, the wireless equipment will have a label affixed to it which indicates that it has the required permit to operate in the venue. Failure to apply for radio frequency coordination and/or the absence of a label will result in the denial of entry to the venue for that wireless equipment.

Individuals who wish to use mobile phones, laptops, PDAs or smart phones do not need to register their equipment via this process. For more information and support please contact the Munich 2022 Spectrum Management team via email at ec22_spectrum@riedel.net.

SMOKING POLICY

Smoking in public buildings and on public transport is prohibited.

MONEY

The official currency in Germany is the Euro (€, code: EUR). Cash machines (ATMs) can be found in front of banks, supermarkets, and frequented public places/areas. Additionally, many supermarkets offer cash withdrawals at the checkout. You will receive a notification if the transaction includes a charge for the withdrawal. Most shops and restaurants accept debit and credit cards.

LANGUAGE

The national language is German.

TAP WATER

Tap water can be consumed safely unless otherwise signposted.

ELECTRICITY

Standard power sockets operate at 230 volts. A Type C, also called the Europlug, or a Type F, also called Schuko, plug or converter is required to use electrical appliances.

TELEPHONE

The country code for Germany is +49.

MEDICAL/EMERGENCY

Medical service will be provided at the official competition, warm-up and training venues. Trained medical staff will be in place during the opening hours at all official venues.

If a medical emergency occurs, please search for the next medical centre or approach the nearest medical team.

HOSPITALS

To provide the best care for the athletes in case of injuries, the medical service provider has a list of hospitals, where all athletes of the European Championships will get preferred treatment.

This service is set in place and will get communicated via the medical director or the medical service provider at all official venues.

Hospital	Address	Telephone	Specialties
Klinikum der Barmherzigen Brüder München	Romanstraße 93, 80639 Munich	+49 89 17970	gastroenterology, cardiology, orthopaedics, sport orthopaedics, surgery, trauma surgery
Klinikum rechts der Isar	Ismaninger Straße 22, 81675 Munich	+49 89 41400	gastroenterology, cardiology, orthopaedics, sport orthopaedics, surgery, trauma surgery, neurology, ophthalmology, mouth jaw & facial surgery, neurosurgery, gynaecology, haemato-oncology
Augustinum	Wolkerweg 16, 81375 Munich	+49 89 70970	cardiology
Schön Klinik Harlaching	Harlachinger Straße, 51, 81547 Munich	+49 89 62112244	orthopaedics
Präventive Sportmedizin und Sportkardiologie der TU München	Georg-Brauchle-Ring 56/58, 80992 Munich	+49 89 28924441	sports medicine

URGENT MEDICAL CARE

Outside the official opening hours at the official venues, there is a 24/7 on-call number available for all athletes. This number can be called if medical advice is needed.

On-call number: +49 89200045640

For urgent medical emergencies, which occur outside of competition or training call 112.

EMERGENCY

These are the emergency numbers, which should be dialled in case of an emergency:

Police: 110

Fire Brigade and Ambulance: 112

In case of emergency make sure to follow these five aspects:

- Where are you? Where is emergency care required?
- What happened or is happening?
- How many people are affected?
- What type of damages or injuries are occurring?
- Wait for further queries or consultation!

OFFICIAL DOCTOR

The official race doctor is Dr. Dirk Tenner (Tel.: +49 162 271 5860; Email: dirk.tenner@t-online.de)

MUNICH 2022 STUDY

The study is about injuries and illnesses during and just before a multi-sport event. In the context of the European Championships the study team will collect anonymous data about injuries and illnesses during training, warm-up and competition.

Therefore, a study team will be present at the medical centre of all official venues and will document the injuries and illnesses. The aim of the study is a better care for athletes during multi-sport events. It is important to ensure better planning for athletes and organisers with a scientific foundation.

COVID-19 MEASURES AND RECOMMENDATIONS

Entry and quarantine regulations:

Information for all participants from abroad:

- As of June 1, entrants no longer need proof that they have been vaccinated, recovered or tested
- Exception: entry from a virus variant area. Here, the existing strict registration, proof and quarantine regulations still apply.

For participants after stays in virus variant areas applies:

- An electronic entry registration (<https://www.einreiseanmeldung.de>)
- A quarantine obligation of 14 days, also with vaccination or proof of recovery

General recommendations for behaviour

The legislator describes the following general behavioural recommendations in the current Infection Protection Measures Ordinance:

- Distance

Wherever possible, a minimum distance of 1.50 m should be maintained.

- Hygiene measures

Hygiene rules should be observed at all times. This includes frequent and thorough hand washing as well as coughing and sneezing into the crook of the arm or into a paper handkerchief in everyday life.

- Wear a mask

Especially indoors or if a distance of 1.50 m from others cannot be safely maintained, a FFP2 mask should be worn.

- Ventilation of indoor areas

In closed rooms, care should be taken to ensure adequate ventilation.

- FFP2 mask

It is recommended to wear a FFP2 mask indoors and in transport vehicles during the European Championships Munich 2022.

Sufficient FFP2 masks will be provided to the participants. The FFP2 masks are to be worn only for single use or for the duration of one working day and then disposed of.

In outdoor areas it is recommended to always keep the minimum distance of 1.50 m between each other.

- Hand hygiene

For thorough hand hygiene, frequent hand washing (30 seconds with soap and water, followed by thorough rinsing) is recommended.

Sufficient disinfection dispensers are available for the use of hand disinfection, e.g. before entering and when leaving the venues.

- Management of suspected Covid-19 cases and confirmed infections

If a Covid-19 infection is suspected, daily testing services are available to athletes and their teams.

If there is a positive result from an antigen test, the affected person should undergo PCR testing and be placed in isolation until the result is known.

Currently, the isolation period after a positive Covid-19 test is 5 days. Access to the sports facility is then possible again if symptoms are absent for 48 hrs. If symptoms persist, isolation must be continued until signs of an acute Covid-19 disease have been absent for 48 hours, but for a maximum of 10 days.

"Close contacts" only need to be in isolation if they have also tested positive, according to the current regulation.

SOCIAL MEDIA

Munich 2022 encourages and fully supports athletes, as well as other accredited persons, to engage in social media activities throughout the duration of the European Championships. Munich 2022 wants as many athletes and team staff as possible to share their experiences and successes at the European Championships. It is important to note the following:

Athletes and team staff do not have the right to publish any video footage filmed in competition areas. All social media activities should be in a first-person, diary-type format and not in the role of a journalist, for example, reporting competitions. Posts may not include any information, which is confidential or private, in relation to any other person or organisation. Social media posts and blogs should always support the spirit of the European Championships and shall not be discriminatory, offensive, hateful, defamatory or otherwise illegal and shall not contain vulgar or obscene words or images.

In addition, they should not:

- Intrude upon the privacy of participants or other accredited persons and entities
- Interfere with the competitions or the ceremonies of the European Championships
- Violate security measures.

If team staff want to film and publish non-live/delayed video material (that does not contain competition footage) from the Mixed Zone, they require prior approval as a Non-Rights Holder (more details here: mediaaccreditation@munich2022.com).

Please feel free to tag the official Munich 2022 channels in all your posts using the official hashtags #Munich2022 and #BackToTheRoofs:

Facebook: [@ECMunich2022](https://www.facebook.com/ECMunich2022)

Instagram: [@munich2022](https://www.instagram.com/munich2022)

Twitter: [@ECMunich2022](https://twitter.com/ECMunich2022)

LinkedIn: [European Championships Munich 2022](https://www.linkedin.com/company/european-championships-munich-2022)

YouTube: [Munich 2022](https://www.youtube.com/channel/UCMunich2022)

USE OF DRONES

The use of drones is prohibited during all Cycling competitions at European Championships Munich 2022.

OFFICIAL OPENING MUNICH 2022

The official opening of the European Championships Munich 2022 will take place in Olympiapark on 10 August 2022, ringing in and raising the excitement for 11 action-packed days of sports and festival. The programme is based on **the organisers' overall vision of creating a unique event experience** for everybody, providing memorable moments of happiness.

The schedule as well as details on the featured athletes, guests and show acts will be communicated in due course.

THE ROOFS (FESTIVAL OF MUNICH 2022)

The Roofs is a festival of diversity and surprise accompanying the European Championships with a mix of music, culture, art, food and much more. Combining big-name headliners with a lovingly curated programme, The Roofs creates special moments that make Munich 2022 a holistic event experience. The festival is made up of 11 Roofs,

each with their own character **and charm**. **There's** something on offer for young and old alike. Plus, the entire programme is free of charge.

[Discover The Roofs](#)

ATHLETES' ROOF (OLYMPIAPARK)

The Athletes' Roof, featuring the Red Bull Energy Station, will be the go-to spot for all athletes competing at European Championships Munich 2022. Hanging out with teammates, recharging after the competition, watching events live, cheering on compatriots or getting to know other athletes from all over Europe – the Energy Station underlines and bundles the beauty of the multi-sport European Championships. **There's something on offer for everyone** to take in the Munich 2022 experience, and much more. The outdoors chill-out area awaits with additional varied activities. Stay tuned! The Athletes' Roof in Olympiapark will be open daily from 10–21 August; the exact opening hours will be communicated shortly. **We can't wait** to host you!

ATHLETES' TICKETS

In the spirit of the multi-sport event, accredited athletes will have the opportunity to attend events of all nine sports free of charge. Please note that the number of available seats depends on the capacity and occupancy of the venues. Reservations are generally not possible, and access will be granted on site and is subject to availability. In general, no tickets will be issued. On site, the athlete can enter the venue through a specially assigned entrance (usually located at the main entrance). Admission will be granted upon presentation of a valid Munich 2022 accreditation. There is no fixed entitlement to a seat. As soon as the ticket holder claims her or his seat, the athlete must release the seat and find an alternative available seat. In most venues there will be a designated area for athletes.

The current ticket sales status is available in the [European Championships Munich 2022 web shop](#). By clicking on the corresponding session, the current availability can be checked. In general, a distinction is made as follows:

Available (High probability of access to the respective event).

Limited Availability (The probability of access to the event is limited and cannot be guaranteed on site).

Not available (Access to the respective event is not possible).

Ticket availability can change at short notice; therefore, access is not guaranteed.

To allow other athletes access to the venue, it is important to again use the exclusive entrance when leaving the venue. This will ensure that a ticketing volunteer frees up a space in the system and another athlete can visit the event.

SPECTATORS' TICKETS

As a multi-sport event, European Championships Munich 2022 hosts nine different sports. In addition to the Track Cycling competitions, there's **numerous** other sports spectators can enjoy and buy tickets for. Some sports (e.g. all other cycling disciplines) are even free of charge. Please visit the [European Championships Munich 2022 web shop](#) for ticket information **and don't hesitate to share this information** with your contacts.

SUSTAINABILITY

GENERAL INFORMATION: As LOC we are aware of our responsibility towards nature, society and the economy and are committed to actively contribute to local and global sustainability. We have developed a sustainability strategy that prioritises six focus areas: (1) Reuse of sports facility and equipment, (2) transport and mobility, (3) waste and

littering, (4) impact on grassroots and professional sports, (5) inclusion and accessibility, (6) local value creation. The [sustainability strategy](#) was published in November 2021 and the sustainability post-event report will follow in December 2022. Questions can be directed to countandlast@munich2022.com regarding sustainability.

ACCESSIBILITY: Please contact inclusion@munich2022.com when accessibility/mobility assistance is needed.

WASTE MANAGEMENT: Our waste management is based on the principles: rethink, reduce, reuse, recycle. In this sense, all together we try to produce as little waste as possible and avoid littering. For recycling we will set up waste stations to sort the waste by type. Additionally, standard bins will be placed at the venue for residual waste collection. All attendees are encouraged to use the recycling waste stations and bins all over the venue.

EUROPEAN CHAMPIONSHIPS MUNICH 2022 – SPORTS PROGRAMME

SPORT / DISCIPLINE	VENUE	11 THU	12 FRI	13 SAT	14 SUN	15 MON	16 TUE	17 WED	18 THU	19 FRI	20 SAT	21 SUN
Athletics	Olympiastadion					🏆	🏆	🏆	🏆	🏆	🏆	🏆
Athletics Marathon	Munich City Centre					🏆						
Athletics Race Walking	Munich City Centre						🏆				🏆	
Beach Volleyball	Königsplatz										🏆	🏆
Canoe Sprint	Munich Olympic Regatta Centre									🏆	🏆	🏆
Cycling Track	Messe München	🏆	🏆	🏆	🏆	🏆	🏆					
Cycling Road	Munich City Centre				🏆			🏆				🏆
Cycling Mountain Bike	Olympiapark									🏆	🏆	
Cycling BMX Freestyle	Olympiapark		🏆	🏆								
Artistic Gymnastics	Olympiahalle	🏆		🏆	🏆				🏆		🏆	🏆
Rowing	Munich Olympic Regatta Centre			🏆	🏆							
Sport Climbing Boulder	Königsplatz			🏆	🏆							
Sport Climbing Lead	Königsplatz			🏆	🏆							
Sport Climbing Speed	Königsplatz					🏆						
Sport Climbing Boulder & Lead	Königsplatz							🏆	🏆			
Table Tennis Doubles	Rudi-Sedlmayer-Halle					🏆			🏆			
Table Tennis Singles	Rudi-Sedlmayer-Halle											🏆
Triathlon	Olympiapark		🏆	🏆	🏆							
 MEDAL EVENTS		1	8	21	24	14	12	9	10	20	23	35



TRACK CYCLING INFORMATION

OFFICIALS

UEC TRACK COMMISSION

President	Jos Smets (BEL)
Member	Miriam Welte (GER)
Member	Daniel Gisiger (SUI)
Member	Martin Lollesgaard (DEN)
Member	Gabriel Mendes (POR)
Member	Pascal Sergent (FRA)

COMPOSITION OF THE COMMISSAIRES' PANEL

President of the Commissaires' Panel	Hans-Christian Lykkegaard (DEN)
Starter	Peter Judez (SLO)
Judge Referee	Edwin Crujssen (NED)
Race Secretary UEC	Linno Nossa (POR)
Commissaire	Andreas Gensheimer (GER)
Commissaire	Tim Gutmann (GER)
Commissaire	Rauthgundis Höschen (GER)
Commissaire	Marina Müller (GER)
Commissaire	Lukas Tutschke (GER)
Commissaire	Markus Gensheimer (GER)
Commissaire	Susann Kapser (GER)
Commissaire	Stefanie Lindemann (GER)
Commissaire	Wolfgang Schwab (GER)
Commissaire	Christian Schröder (GER)
Commissaire	Vanessa Leske (GER)
Doping Control Officer	N.N.
Derny pilot	Peter Bäuerlein (GER)
Derny pilot	Mario Vonhof (GER)

COMPETITION VENUE / TEAM PARKING AREA

Messe München – Hall C1
Paul-Henri-Spaak-Straße
Gate 19
81829 Munich



PERMANENCE

A Permanence Desk is located on the 1st floor in Hall C1 and will be open throughout all training and competition sessions when athletes can access the venue.

The Permanence is the contact point for all organisational and non-sporting matters of the athletes or teams. Access to the Permanence is limited to team managers only, who can address the Permanence on behalf of the entire team. Among other things, the key for the team containers in the Athletes' Area can be collected here for a deposit of €50.

Opening Hours Messe München Track Cycling Permanence:

Date	Open	Close
8 August	07:30	18:00
9 August	06:30	22:00
10 August	07:30	22:00
11 August	07:30	20:30
12 August	08:30	20:30
13 August	06:30	22:00
14 August	09:00	22:00
15 August	08:30	21:00
16 August	08:30	20:30

OFFICIAL MEETINGS SCHEDULE

CONFIRMATION OF STARTERS

Team managers must confirm all starters, present licences and provide a sample of the team clothing.

Wednesday, 10 August 2022 11:00-13:00

Messe München – Hall C1

Paul-Henri-Spaak-Straße

Gate 19

81829 Munich

Confirmation of Starters / Team Managers' Meeting Room (1st floor)

TEAM MANAGERS' MEETING

Wednesday, 10 August 2022 18:00-19:00

Messe München – Hall C1

Confirmation of Starters / Team Managers' Meeting Room (1st floor)

Rider numbers will be distributed at the Team Managers' Meeting. Attendance is restricted to two persons per team.

COMMISSAIRES' PANEL MEETING

Wednesday, 10 August 2022 10:00-10:45

Messe München – Hall C1

Confirmation of Starters / Team Managers' Meeting Room (1st floor)

TRAINING SCHEDULE

Pre-event team training cannot be booked. We offer three official training days before the event (from 9–11 August), where different nations are allowed to train on the track. Unfortunately, training is not possible prior to these dates. The exact training schedule with the respective times for all nations will be published at the beginning of August, after the registration of all riders is completed.

COMPETITION SCHEDULE

The Competition Schedule is subject to change.

Training, Tuesday, 9 August

Start	End	Event
08:00		Venue opens
09:00	approx. 21:00	Training
	22:00	Venue closes

Training, Wednesday, 10 August

Start	End	Event
08:00		Venue opens
09:00	approx. 21:00	Training
10:00	10:45	Commissaires' Panel Meeting
11:00	13:00	Confirmation of Starters
18:00	19:00	Team Managers' Meeting
	22:00	Venue closes

Training & Qualification (Day 1), Thursday, 11 August

Start	End	Gender	Event
08:00			Venue opens
09:00	15:00		Training
15:00	15:50		<i>Warm-up (only for riders taking part in the competition that day)</i>
16:00		Women	Team Sprint – Qualification
		Men	Team Sprint – Qualification
		Women	Team Pursuit – Qualification
	19:30	Men	Team Pursuit – Qualification
	20:30		Venue closes

Day 2, Friday, 12 August

Morning session

Start	End	Gender	Event
08:30			Venue opens
10:00	11:50		<i>Warm-up (only for riders taking part in the competition that day)</i>
12:00		Women	Team Sprint – 1 st round
		Men	Team Sprint – 1 st round
		Women	Team Pursuit – 1 st round
		Men	Team Pursuit – 1 st round
		<i>Women</i>	<i>Scratch Race - Qualification (if necessary)</i>
	15:00	<i>Men</i>	<i>Points Race – Qualification (if necessary)</i>

Evening session

Start	End	Gender	Event
15:20	16:20		<i>Warm-up (only for riders taking part in the competition that day)</i>
16:30		Women	Team Pursuit – Finals
		Men	Team Pursuit – Finals
		Women	Team Pursuit – <i>Medal Ceremony</i>
		Men	Team Pursuit – <i>Medal Ceremony</i>
		Women	Team Sprint – Finals
		Men	Team Sprint – Finals
		Women	Team Sprint – <i>Medal Ceremony</i>
		Women	Scratch Race – Final 10km
		Men	Team Sprint – <i>Medal Ceremony</i>
		Men	Points Race – Final 40km
		Women	Scratch Race – <i>Medal Ceremony</i>
	19:30	Men	Points Race – <i>Medal Ceremony</i>
	20:30		Venue closes

Day 3, Saturday, 13 August

Morning session

Start	End	Gender	Event
06:30			Venue opens
08:00	09:50		<i>Warm-up (only for riders taking part in the competition that day)</i>
10:00		Men	Sprint – Qualification
		Women	500m Time Trial – Qualification
		Men	Sprint – 1/16 finals
		Women	Individual Pursuit – Qualification
		Men	Individual Pursuit – Qualification
		Women	<i>Elimination – Qualification (if necessary)</i>
	15:15	Men	<i>Scratch Race – Qualification (if necessary)</i>

Evening session

Start	End	Gender	Event
16:00	17:20		<i>Warm-up (only for riders taking part in the competition that day)</i>
17:30		Men	Sprint – 1/8 finals
		Women	500m Time Trial – Final
		Women	Individual Pursuit – Finals
		Women	500m Time Trial – <i>Medal Ceremony</i>
		Women	Individual Pursuit – <i>Medal Ceremony</i>
		Men	Sprint – Quarterfinal, 1 st heat
		Men	Sprint – Quarterfinal, 2 nd heat
		Men	Individual Pursuit – Finals
		Men	Sprint – Quarterfinal, decider
		Women	Elimination – Final
		Men	Individual Pursuit – <i>Medal Ceremony</i>
		Men	Scratch Race – Final 15km
		Women	Elimination – <i>Medal Ceremony</i>
	21:00	Men	Scratch Race – <i>Medal Ceremony</i>
	22:00		Venue closes



Day 4, Sunday, 14 August

Morning session

Start	End	Gender	Event
09:00			Venue opens
10:30	12:20		<i>Warm-up (only for riders taking part in the competition that day)</i>
12:30		Women	Sprint – Qualification
		<i>Women</i>	<i>Points Race – Qualification (if necessary)</i>
		<i>Men</i>	<i>Elimination – Qualification (if necessary)</i>
	15:00	Women	Sprint – 1/16 finals

Evening session

Start	End	Gender	Event
16:20	17:35		<i>Warm-up (only for riders taking part in the competition that day)</i>
17:45		Women	Sprint – 1/8 finals
		Men	Sprint – Semi-final 1 st heat
		Women	Sprint – Quarterfinal, 1 st heat
		Men	Sprint – Semifinal 2 nd heat
		Women	Sprint – Quarterfinal, 2 nd heat
		Men	Sprint – Semifinal decider
		Women	Sprint – Quarterfinal, decider
		Women	Points Race – Final 25km
		Men	Sprint – Finals 1 st heat
		Women	Points Race – <i>Medal Ceremony</i>
		Men	Elimination – Final
		Men	Sprint – Finals 2 nd heat
		Men	Elimination – <i>Medal Ceremony</i>
		Men	Sprint – Finals decider
	21:00	Men	Sprint – <i>Medal Ceremony</i>
	22:00		Venue closes

Day 5, Monday, 15 August

Morning session

Start	End	Gender	Event
08:30			Venue opens
10:00	11:50		<i>Warm-up (only for riders taking part in the competition that day)</i>
12:00		Men	Omnium – Qualification (if necessary)
		Women	Omnium – Qualification (if necessary)
		Men	1km Time Trial – Qualification
		Women	Omnium – Race I – Scratch Race 7.5km
	14:50	Men	Omnium – Race I – Scratch Race 10km

Evening session

Start	End	Gender	Event
15:00	15:35		<i>Warm-up (only for riders taking part in the competition that day)</i>
15:45		Women	Sprint – Semifinal, 1 st heat
		Women	Omnium – Race II – Tempo Race 7,5km
		Women	Sprint – Semifinal, 2 nd heat
		Men	Omnium – Race II – Tempo Race 10km
		Women	Sprint – Semifinal, decider
		Men	1km Time Trial – Final
		Women	Omnium – Race III – Elimination race
		Women	Sprint – Finals 1 st heat
		Men	1km Time Trial – <i>Medal Ceremony</i>
		Men	Omnium – Race III – Elimination race
		Women	Sprint – Finals 2 nd heat
		Women	Omnium – Race IV – Points race 20km
		Women	Sprint – Finals, decider
		Men	Omnium – Race IV – Points race 25km
		Women	Omnium – <i>Medal Ceremony</i>
		Women	Sprint – <i>Medal Ceremony</i>
	19:45	Men	Omnium – <i>Medal Ceremony</i>
	21:00		Venue closes

Day 6, Tuesday, 16 August

Morning session

Start	End	Gender	Event
08:30			Venue opens
10:00	11:50		<i>Warm-up (only for riders taking part in the competition that day)</i>
12:00		Women	<i>Madison – Qualification (if necessary)</i>
		Men	<i>Madison – Qualification (if necessary)</i>
		Women	Keirin – 1 st round
		Men	Keirin – 1 st round
		Women	Keirin – 1 st round repechages
	15:15	Men	Keirin – 1 st round repechages

Evening session

Start	End	Gender	Event
15:30	16:20		<i>Warm-up (only for riders taking part in the competition that day)</i>
16:30		Women	Keirin – Semifinals
		Men	Keirin – Semifinals
		Women	Madison – 30km
		Women	Keirin – Finals
		Women	Madison – <i>Medal Ceremony</i>
		Men	Keirin – Finals
		Women	Keirin – <i>Medal Ceremony</i>
		Men	Madison - Final
		Men	Keirin – <i>Medal Ceremony</i>
	19:30	Men	Madison – <i>Medal Ceremony</i>
	20:30		Venue closes

TRACK SPECIFICATIONS

Length: 200m temporary track

Width: 7m

Bend inclination: max. 44°

Straight inclination: min. 12.5°

Bend radius: 18.5m

Length of straights: 43.13m

Length of bends: 56.87m

Width safety zone: 3.5m

Track surface: Spruce plywood panels

Architect & track builder: VeloTrack

TRACK CENTRE – TEAM BOXES

Team boxes are situated in the track centre for use from 9 August 2022 onwards. The size of the boxes depends on the number of athletes per nation. As space is limited, we recommend to only bring strictly required material. Escape and emergency routes must be kept clear under all circumstances.

To still guarantee enough space for the athletes, we offer an extra Recovery Area outside of the track centre but inside the building where athletes can follow their pre- and post-competition routines quietly and concentrated.

RIDER SAFETY RULES

While on the track, riders must wear a helmet. Moreover, no road bikes are allowed on the track. The use of personal stereo or Go-Pro camera equipment and headphones, while riding on the track, is forbidden. The use of any deryn or starting gate during official training is not permitted.

TEAM MEDICAL

Official race doctors and a team of paramedics will be present in the track centre – other medical assistance is also available in an Athletes' Medical Room outside of Hall C1 (next to the Athletes' Lounge).

TEAM PERFORMANCE ANALYSTS

An area for performance analysts will be provided. Teams wishing to use this facility must book a position for a fee of €80 via trackcycling@munich2022.com as space is limited. A position cannot be guaranteed. Space will be allocated on a "first come, first served" principle.

Upon arrival and before use, the equipment must be registered at the Permanence Desk. The video recordings and other content regarding the video performance analysts can only be used for internal analysis purposes on site. Publication of contents is prohibited under all circumstances. A corresponding form must be signed by teams/performance analysts in which they guarantee the private keeping of contents.

An internet connection will be provided. It is prohibited for teams to use their own Wi-Fi as it may interfere with other wireless connections. Wi-Fi activity will be monitored throughout the event.

ON-BIKE CAMERAS

For Track Cycling events on-bike cameras will be used for live broadcasting purposes as the perspective from these cameras offers TV audiences a great visual experience of what it is like to race. The cameras will be mounted underneath the saddle pointing backwards.

A team that will attach the cameras securely to the bikes will be based in the track centre and will cooperate with team mechanics to fix the mounts before the competitions start. To compensate the extra weight of the camera, all other riders in individual competitions – also in bunch races - will carry a dummy.

For team events the National Federations will be asked to nominate riders whose bikes will be equipped with the on-bike cameras.

The cameras including the mounts will immediately be removed after the end of the respective competition.

Our production team using these cameras has major event experience and good relations with Cycling team leaders.

The UCI has approved their on-bike camera system.

INTERVIEW MIXED ZONE

A Mixed Zone where media and broadcast can conduct a short interview with riders is located at the exit of the track. Riders are obliged to go through the Mixed Zone after their respective last race of the day or of the competition and are asked to give interviews. When athletes must attend the Medal Ceremony shortly after the race, they are required to pass the Live Broadcast Mixed Zone immediately after the race and the Press Mixed Zone after the Medal Ceremony.

RESULTS DISTRIBUTION

Results will be available via our [Munich 2022 website](#) and will also be displayed on a notice board next to the Commissaires' Podium near the finish line.

ROLLERS

Riding bicycles in the corridors of Hall C1 is prohibited at all times. Teams are allowed to bring their own rollers to a limited extent and these rollers are only to be ridden in the infield or in the Recovery Area. The LOC will provide a limited number of rollers.

TEAM STORAGE AREA

Our storage area for teams/athletes is located outside of Hall C1. The amount of space for one nation depends on the number of riders per nation.

Access to the containers will be granted for a deposit of €50. Keys can be collected at the Permanence.

ATHLETES' LOUNGE AT THE VENUE

Our Athletes' Lounge is located outside of Hall C1 in the Athletes' Area. Snacks and beverages will be provided.

TEAM CHANGING ROOMS & SHOWERS

Women's and men's changing rooms and showers are located outside of Hall C1 in the Athletes' Area.

ICE BATH

Athletes can use the ice bath right next to the Athletes' Lounge outside of Hall C1 to cool down and regenerate between races.

SEATING OPTIONS FOR ATHLETES

Athletes are welcome to watch the ongoing competitions from the grandstand, provided there are enough free seats and tickets are not sold out. Seats are not explicitly kept free for athletes, so a free seat cannot be guaranteed, and the seats must be given up when ticket holders arrive.

TEAM CATERING AT THE VENUE

Catering will not specifically be provided for the teams, however, please note there are numerous options available on site.

TEAM CATERING AT THE HOTEL

For teams that have booked their hotel through our EMS, catering will be provided in accordance with their booking. The catering times are set in agreement with the hotel and adapted to the schedule. The meals are based on the specifications and recommendations of the UEC. Teams are not allowed to bring their own cooks due to hygienical restrictions in Germany.

ANTI-DOPING CONTROL

Anti-doping controls will fall under the responsibility of the National Anti-Doping Agency Germany (NADA). The appointed Doping Control Officer will circulate an official communiqué.

The tests will be conducted by the PWC (Professional Worldwide Controls) Doping Control Officer in alignment with UCI Regulations. Chaperons must and are allowed to accompany athletes everywhere. It is prohibited for the **athletes' staff to prevent** chaperons from always observing the athlete.

Riders are reminded that it is their responsibility to report for anti-doping control.

The Doping Control Officer is yet to be announced.

TRACK CYCLING VENUE: MESSE MÜNCHEN

TRACK CYCLING VENUE – OVERVIEW

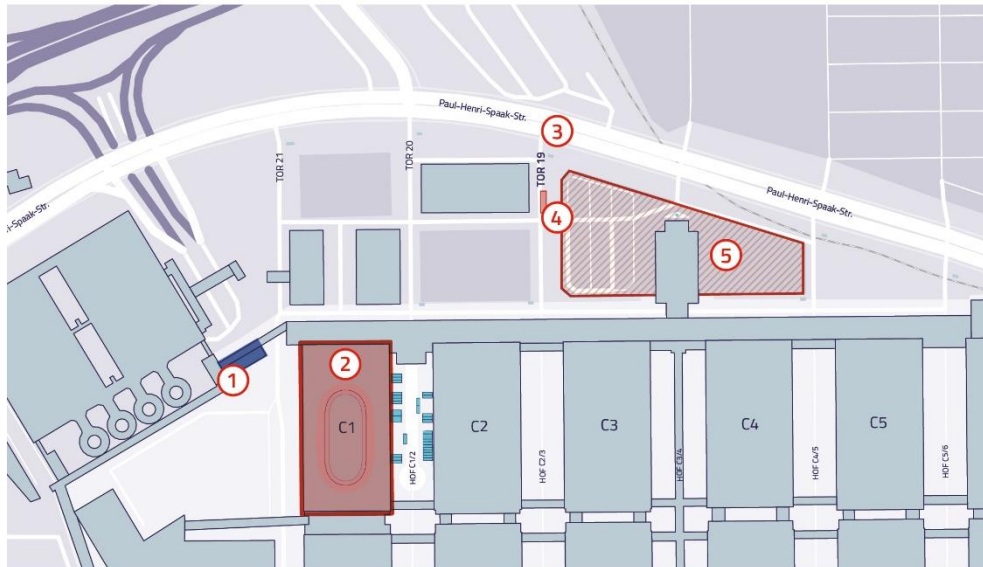

LEGEND

1. Spectators' Entrance
2. Hall C1 – Track Cycling Venue
3. Entrance Team Parking
4. Accreditation Road & Track Cycling Teams / Permanence Road Cycling
5. Team Parking Area (Road & Track Cycling)

TRACK CYCLING VENUE – HALL C1

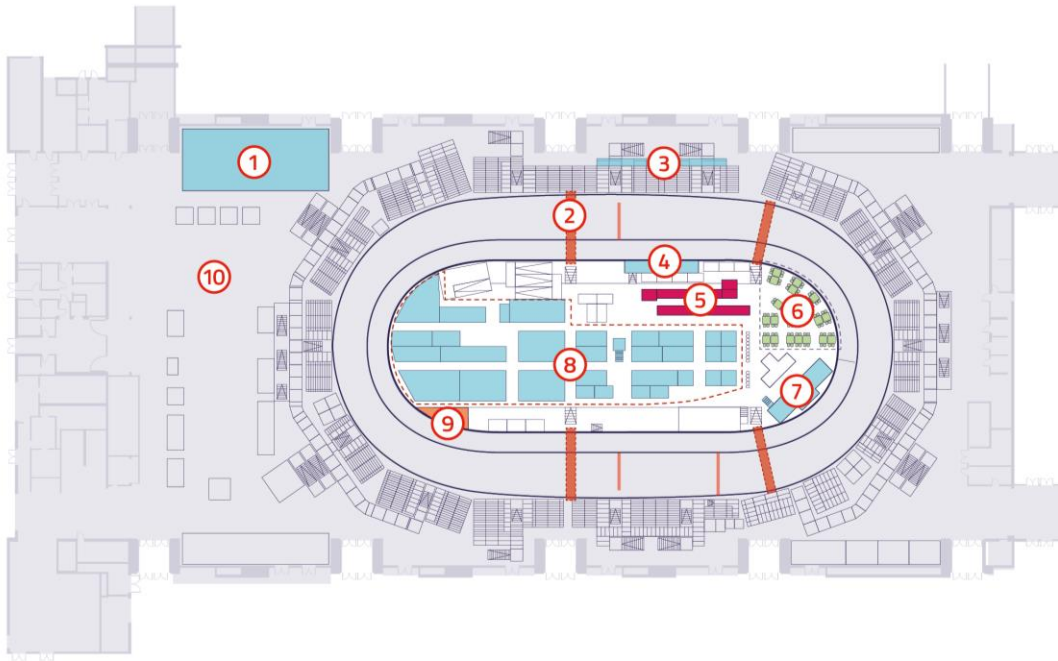

LEGEND

- | | | | |
|----|---------------------------|-----|-------------------------|
| 1. | Recovery Area | 6. | Media Area |
| 2. | Athletes' Tunnel | 7. | Podium |
| 3. | Performance Analysis Area | 8. | Team Area |
| 4. | Coaches Podium | 9. | Medical |
| 5. | Mixed Zone | 10. | Public Food & Beverages |

TRACK CYCLING VENUE – ATHLETES' AREA

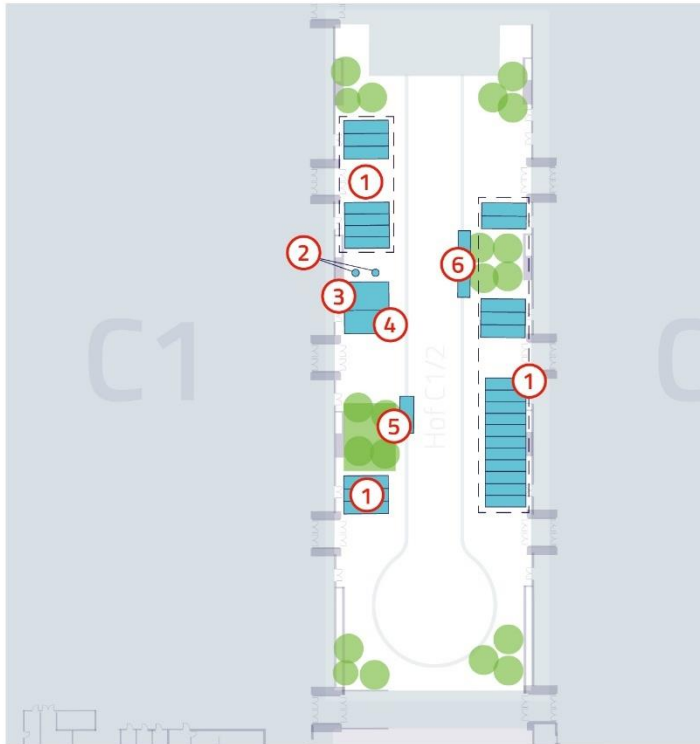

LEGEND

1. Team Storage
2. Ice Bath
3. Athletes' Lounge
4. Changing Rooms
5. Medical Tent
6. WC / Showers

TRACK CYCLING VENUE – 1st FLOOR

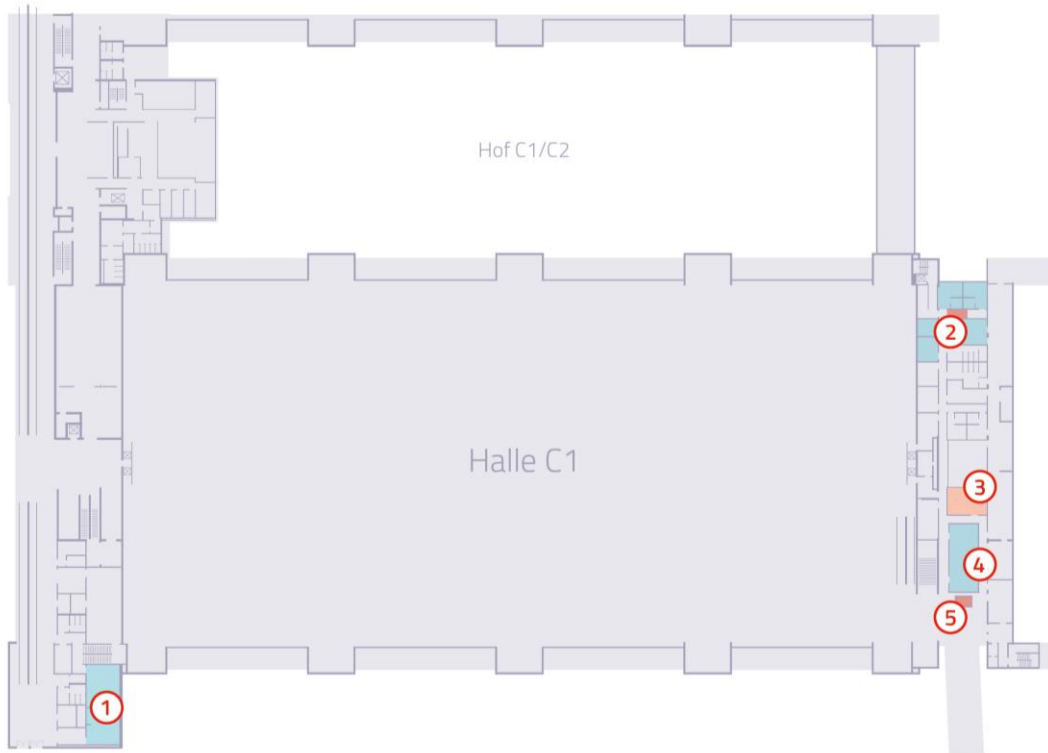

LEGEND

1. Confirmation of Starters / Team Managers' Meeting Room
2. Doping Control Station
3. Commissaires' Office
4. LOC Office
5. Permanence Track Cycling

TRACK ELITE EUROPEAN CHAMPIONSHIPS SPECIFIC REGULATIONS 2022

ARTICLE 1. GENERAL RULES

1.1 The 2022 UEC Track Elite European Championships are organised by the Union Européenne de Cyclisme (UEC) in cooperation with the LOC Office, European Championships Munich 2022. Technical preparation and coordination will be conducted by the LOC.

Competition Manager: Alexander Donike

1.2 The event will be organised in accordance with the rules of the Union Cycliste Internationale (UCI) and these rules will be the reference for everything that is not mentioned in the current document.

1.3 The European Championships will be organised for the following disciplines. These Championships may be contested by riders entered by their National Federation as a National Team.

Disciplines

Men	Women
Sprint	Sprint
Keirin	Keirin
Team Sprint	Team Sprint
TT 1 km	TT 500 m
Team Pursuit 4 km	Team Pursuit 4 km
Individual Pursuit 4 km	Individual Pursuit 3 km
Scratch	Scratch
Madison	Madison
Omnium	Omnium
Elimination Race	Elimination Race
Points Race	Points Race

The detailed competition schedule for all races in all disciplines can be found earlier in this document on [pp. 21-26](#).

1.4 Body numbers – Clothes

The riders are obliged to use the body numbers which will be supplied by the organisation. Body numbers may not be folded or altered. Riders must compete in their national jersey.

Riders shall wear one (1) body number in the following events:

- TT 500 m
- TT 1 km
- Team Sprint (each rider one number)
- Individual Pursuit
- Team Pursuit (each rider one number)

Riders shall wear two (2) body numbers in all other races, Omnium included.

Riders competing in Madison will receive dedicated body numbers.

1.5 Publication

All results, rankings and communiqués will be published on the notice board. Results will also be published on the UEC website: www.uec.ch and on the official Munich 2022 website: www.munich2022.com.

1.6 Unforeseen

In those events in which the regulations do not specify, the Commissaires' Panel, in conjunction with the UEC Technical Delegate and the organisation (where applicable), will decide.

ARTICLE 2. TYPE OF EVENT

2.1 The event is open to athletes of the Men Elite (ME) and Women Elite (WE) categories.

2.2 It is entered on the UCI calendar as a Continental Championships event (CC).

ARTICLE 3. PARTICIPATION

3.1 National Federations may nominate the following riders/teams to the events:

Event	Entered	Starters
Sprint	4	2
Keirin	4	2
Team Sprint	4	3 (=1 team)
TT 500 m or 1 km	4	2
Individual Pursuit	4	2
Team Pursuit	5	4 (=1 team)
Points Race	3	1
Scratch Race	3	1
Omnium	3	1
Madison	4	2 (=1 team)
Elimination Race	3	1

Where the number of entries for an event exceeds the track limit, qualification heats will run according to the competition schedule.

3.2 Riders' ages shall be calculated as defined by the UCI rules. Generally, the age of a rider shall be determined by the difference between the year of the event and the year of birth of the rider.

3.3 Nevertheless, considering UCI rules, articles 1.1.034, 3.2.001, 3.4.004, 9.2.024, 11.1.003 and in accordance with the UCI, the participation at the competitions shall be open to riders aged 18 and over.

3.4 The National Federations have to register their riders directly on the UEC website (www.uec.ch). Entries (riders, staff and NF Official Delegates) must be submitted by the National Federations.

Registration opens on 2 July 2022 (12:00 CET).

Registration deadline is 30 July 2022 (23:59 CET).

Entrants for European Championships shall hold licences issued by a Federation affiliated to the UEC and have the nationality of the Federation doing the entry.

3.5 The confirmation of the starters and the distribution of the race numbers for all disciplines will be placed at the Meeting Room located on the 1st floor of Messe München, enter through Gate 19 at Paul-Henri-Spaak-Straße 10-12, 81829 Munich, Hall C1 as follows:

Wednesday, 10 August 2022: 11:00-13:00

The date and timeframe are subject to change

The riders to contest each championship shall be confirmed by an official of the Federation to the Commissaires, during the confirmation procedure, before the start of the Team Managers' Meeting.

ARTICLE 4. TEAM MANAGERS' MEETING

4.1 The Team Managers' Meeting, organised in accordance with article 1.2.087 of the UCI Regulations in the presence of members of the Commissaires' Panel, will take place at the Meeting Room located on the 1st floor of Messe München, enter through Gate 19 at Paul-Henri-Spaak-Straße 10-12, 81829, Hall C1 as follows:

Wednesday, 10 August 2022: 18:00-19:00

The date and timeframe are subject to change

ARTICLE 5. BICYCLES AND EQUIPMENT CONTROL

5.1 For all disciplines and races, UCI Commissaires will check each bicycle. Each rider must present his/her bicycle for that check and verification prior to their personal start time.

ARTICLE 6. EVENTS REGULATIONS

6.1 Sprint, Individual Pursuit, TT 1 km and 500 m, Points Race, Keirin, Scratch Race, Team Pursuit, Team Sprint, Omnium, Madison.

All the above-mentioned championships will be conducted in accordance with the UCI Regulations and format of the UCI World Championships.

6.2 The seeding for all the above-mentioned championships will be done according to the UCI Regulations article 3.2.021 bis. The current UCI World Champions and the former UEC European Champions of the discipline, can be seeded in the first position.

6.3 Elimination Race (as a championship)

For the start of the race, riders shall line up in single file along the railing and in the sprinter's lane.

Coaches holding their rider in the sprinter's lane are allowed to push them during the start but from a stationary position (both feet on the ground at the same time).

The order of the riders shall be determined according to the UCI Regulations, in respect to the current UCI Elimination Ranking by Nations.

The order for non-ranked nations will be done by drawing lots during the Team Managers' Meeting as follows:

- 1st draw – teams present at the Team Managers' Meeting
- 2nd draw – teams not present at the Team Managers' Meeting

ARTICLE 7. AWARDS

Jersey and medals

Every European Championship medallist will be awarded:

- 1st place: Champion's jersey & gold medal
- 2nd place: silver medal
- 3rd place: bronze medal

In accordance with article 1.2.112 of the UCI Regulations, the best three riders of each category must attend the official awards ceremony.

Winners are required to be on time for the awards ceremony.

Riders must present themselves in race clothing, wearing their national jersey and shall not wear a helmet, a cap, a headband, or glasses until they leave the podium ceremony area.

Prize money

Prize money in Euro (€)

Pos.	Ind. Event	Team Sprint	Team Pursuit	Madison
Men Elite				
1°	€670	€885	€1180	€885
2°	€335	€450	€580	€450
3°	€180	€225	€300	€225
Women Elite				
1°	€670	€885	€1180	€885
2°	€335	€450	€580	€450
3°	€180	€225	€300	€225

ARTICLE 8. ANTI-DOPING

UCI Anti-doping rules are entirely applicable to the event.

Anti-doping tests will take place in the Anti-Doping Area located on the 1st floor of Hall C1 at Messe München.

Anti-doping controls will be the responsibility of the National Anti-Doping Agency Germany (NADA).

ARTICLE 9. PENALTIES

The UCI penalty scale is the only one applicable.

ARTICLE 10. RESPONSIBILITIES

The organisers and UEC will not, under any circumstances, be liable for any accidents or damage or loss that occurs during training and competitions.

The organisers and UEC decline all responsibilities towards the riders and others in case of an accident.

For all cases not covered by these specific regulations, the UCI rules will apply. Any problems will be solved between the organisers, the Commissaires' Panel and UEC officials.



THANK YOU TO OUR PARTNERS

OFFICIAL PREMIUM PARTNERS



FEDERATIONS



HOST INSTITUTIONS

Funded by the



Funded by
Bavarian State Ministry of the
Interior, for Sport and Integration

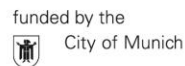

funded by the
City of Munich



EUROPEAN CHAMPIONSHIPS MANAGEMENT



BROADCAST

